

ROLLER SHADE SYSTEM Installation Instructions

Before installing brackets please ensure that surface is secure, clean and level. Incorrect installation will void warranty.

Tools Required:

- Power drill with Philips head tip
- 2.5mm drill bit
- Scissors
- Pencil

Additional fixing parts may be required:

- Wall plugs for gyprock or dry wall if stud can't be found.
- Masonry wall plugs if securing to concrete
- Gyprock toggle if securing into a ceiling
- Tech screw or other for securing to metal



ASSEMBLING & INSTALLING THE BLIND

1. Fix the brackets using timber screws or with additional fixing parts for concrete/steel or other mounting types (not supplied)
2. See bracket mounting options for available options.

Back Mount

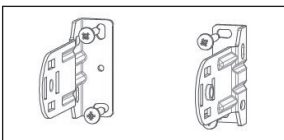

Top Mount

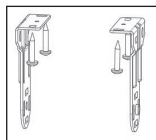

Side Mount

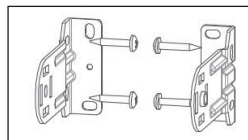

- a. Hold the brackets in position and use a pencil to mark the screw locations.
- b. Pre-drill the screw locations using a 2.5mm drill bit.

3. Install the blind in the brackets by inserting the IDLE END first, then while holding the CHAIN DRIVE side of the blind, gently apply pressure to the idle end which is spring loaded and slot the CHAIN DRIVE into the bracket, making sure the two locator hooks align and snap down, securing the blind in the brackets.

The chain drive must be mounted in a position on the brackets that allows the chain to fall directly down (see Fig 1.1). Do not attempt to mount at a 90 degree angle.

4. If the blind is installed on a window frame face, the bracket covers can be slipped on over the brackets (Fig 1.2). If the blind is installed inside the window frame, covers are not used.

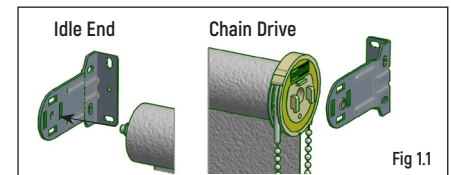

Fig 1.1

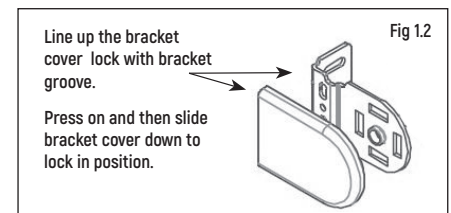

Fig 1.2

Line up the bracket cover lock with bracket groove.

Press on and then slide bracket cover down to lock in position.

INSTALLING THE CHAIN TENSIONING DEVICE

To avoid strangulation hazard, all internal window coverings with a cord/chain control must have a child safety device installed where the cord has the possibility of forming a loop of 220mm or longer and it is at a height of less than 1600mm above the floor level.

A cord guide safety tensioner may be installed lower than 1600mm above floor level if the cord is sufficiently secured or tensioned to prevent a loop 220mm or longer from being formed.

If the cord is installed lower than 1600mm from the floor level it must be designed to prevent a child from being able to remove the cord.

Install the blind first and then follow the instructions below to secure the safety device and label after installation.

1. Thread the chain loop through the safety device. You can do this by disconnecting the chain joiner and running the chain through the safety device, or by separating the clear sections of the safety device and clipping the chain over, as per the image on the right.

Ensure the safety device is able to sit flush with the wall being mounted to, and make sure the chain is not too tight. The chain should flow freely through the safety device and not be under constant strain.

2. Fix the screw through the hole in the safety device to the wall or frame. If fixing to concrete, plasterboard or other materials other than timber, additional wall plugs, or toggles may be required and are not supplied. If fixing to timber ensure you pre-drill the screw hole with a 2.5mm drill bit.
3. Thread the safety clip through the safety label and attach the clip/label to the chain so that it hangs at the bottom and is not removable. The safety label must stay affixed after installation.

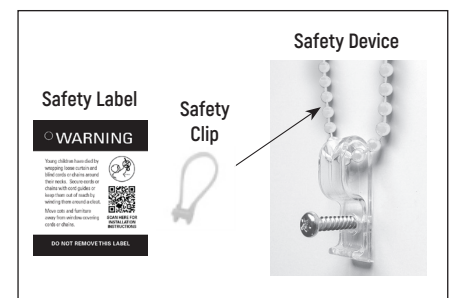

Safety Label

WARNING

Young children have died by strangling in window coverings. Always ensure window coverings are secured to the wall or frame. Do not use window coverings with cords or chains. Always use and fasten safety devices and labels to the cord or chain.

DO NOT REMOVE THIS LABEL.

Safety Clip

Safety Device

WARNING: Be aware that it is possible for children to strangle in window covering chains. To reduce the possibility of such an accident, all chains must be kept out of reach of children, including infants. Please refer to Installation Instructions.

INSTALLATION OF DOUBLE BRACKETS (OPTIONAL)

The double bracket kit allows the installation of two blinds in one window, using one set of brackets.

1. First, follow steps 1 through 4 in the **Installation/Assemble the Blind** instructions.
2. Before installing the dual brackets, determine what side the control operation (chain drive) will be on for each blind.
3. It is possible to have both chain drive controls on the same end, or alternate ends. The picture below shows when the chain diverter needs to be used to stop the chain from the top blind rubbing on the bottom blind (**Fig 2.1**).
4. The chain diverters are marked L-Left and R-Right. Slide the appropriate diverter on as per the image on the right (**Fig 2.2**). To remove the diverter, a screwdriver can be used to wedge up from the bottom and release from the snap.
5. Install the brackets as per instructions on the previous page. Ensure that the safety device is installed for both blinds.



Both Chain Drives
Same Side



Top Chain Drive
Bottom Idle End



Both Idle Ends
Same Side



Top Idle End
Bottom Chain Drive

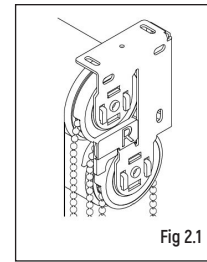

Fig 2.1

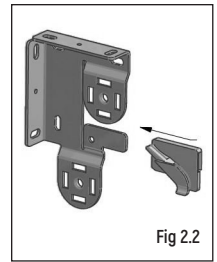

Fig 2.2

INSTALLATION OF SPRING ASSIST (SUPPLIED FOR LARGE HEAVY BLINDS)

The Spring Assist is used to lighten the pull force required to lift and drop large heavy blinds. The spring may be pre-installed in the blind or may require attachment to the chain drive and inserting inside the blind tube. The spring needs to be tuned by applying pre-tension to the chain drive as per below.

Installing Spring and Adjusting:

1. The correct spring will be supplied based on the control side that was selected when the blind was ordered.
2. Clip the spring into the end of the chain drive and slide the supplied wheel over the end of the spring shaft and clip into position (**Fig 3.1**).
3. Slide the spring into the end of the blind tube but do not push all the way in. Stop just short of the point where the chain drive engages with the keyway on the tube (**Fig 3.2**).
4. You must now add tension to the spring in order to balance the weight of the blind.
Add tension by pulling the chain in the direction of lowering the blind, while holding the outer (top and bottom) of the chain drive with your fingers, as per the image below.
Add 4 Complete revolutions and then slide the chain drive into the blind tube, taking care to ensure the chain drive aligns with the keyway on the tube, install the blind and test operation.

If the blind is too heavy to operate in the downward direction (when operating the blind down) you can reduce tension by taking the blind out of the brackets, sliding the chain drive out of the tube and reversing the directions above by operating the chain to raise the blind while holding the outer casing of the chain drive with your fingers. Remove one complete turn, then reinsert the chain drive into the blind, install the blind and test operation (**Fig 3.3**).

The end of the spring clips into the end of the chain drive.

Fig 3.1

Wheel 'Clips' into position

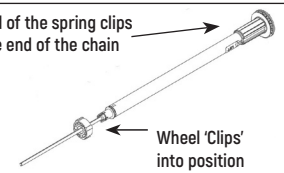

Fig 3.2

Slide into blind

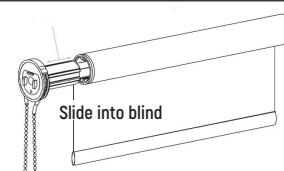
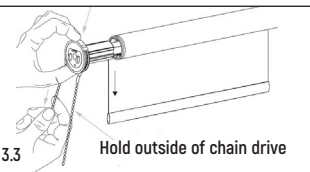

Fig 3.3

Hold outside of chain drive



INSTALLATION OF MULTILINK BLINDS

1. Mount the chain drive end bracket first, then mount the link bracket. Care should be taken to maintain the required gap of 6mm so that there is enough room to slot the master blind in and hook the chain drive into the brackets. Then install the Idle end bracket (**Fig 4.1**).
2. Install the master blind first. Insert the chain drive into the bracket until it engages, then slide the bearing at the other end in the link brackets. If it doesn't go in easily, slightly rotate the bearing until it slides into the bracket (**Fig 4.2**).
3. Install the bearing lock to lock the master blind into position. Rotate the bearing 90 degrees so that one of the holes aligns with the end of the bracket. Insert the bearing lock clip into the slot in the bearing at the end of the bracket, ensuring it clicks into place. (Note. The bearing lock cannot be pulled out once the clip is locked into place) (**Fig 4.3**).
4. Install slave blind by inserting the female drive into the square male drive. Complete blind installation by pushing in the retractable pin with a flat screwdriver and popping the pin into the bracket hole (**Fig 4.4**).
5. To level the blinds: Use the Infinite adjuster spanner to rotate the adjustment nut on the female drive. Adjust the level on the slave blind until the bottom bar becomes level with the master blind. The levelling can be performed in both an UP or DOWN direction (**Fig 4.5**).

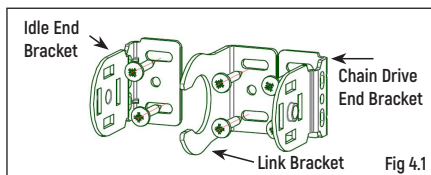

Fig 4.1

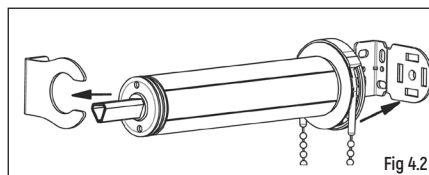

Fig 4.2

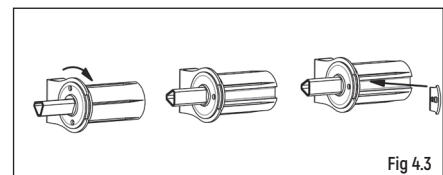

Fig 4.3

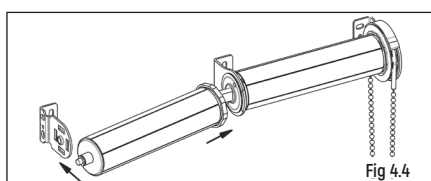

Fig 4.4

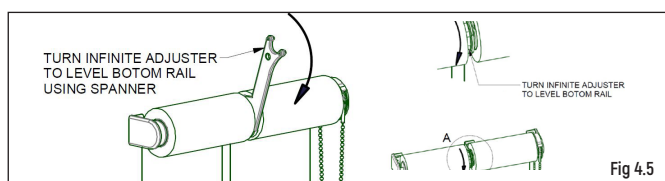

Fig 4.5

CARE & CLEANING

1. Surface dust may be removed with a gentle brush, feather duster or clean, dry cloth.
2. Wipe with a dry sponge.
3. An art gum rubber is excellent for removing small marks.